



LICENSING (HEARING) SUB COMMITTEE

Date: FRIDAY, 15 JULY 2016

Time: 11.00 am

**Venue: COMMITTEE ROOM - 2ND FLOOR
WEST WING, GUILDHALL**

**APPLICANT:
STRADA STRADING LIMITED**

**PREMISES:
4 ST PAUL'S CHURCHYARD, EC4M 8AY**

CONTENTS

Hearing Procedure	(Pages 1 - 2)
Report of the Director of Markets & Consumer Protection	(Pages 3 - 8)
Appendix 1: Copy of Application	(Pages 9 - 26)
Appendix 2: Current licence	(Pages 27 - 34)
Appendix 3: Agreed Condition	(Pages 35 - 36)
Appendix 4: Representations from Other Persons	
i) St Paul's Cathedral School	(Pages 37 - 38)
ii) Church Commissioners	(Pages 39 - 40)
Appendix 5: Map of subject premises together with other licensed premises in the area and their latest terminal time for alcohol sales	(Pages 41 - 42)
Appendix 6: Plan of Premises	(Pages 43 - 44)

LICENSING (HEARING) SUB COMMITTEE PROCEDURE FOR PUBLIC HEARINGS

1. This procedure shall apply to all public hearings conducted under the provisions of the Licensing Act 2003.
2. Public hearings conducted under the provisions of the Licensing Act 2003 shall take the form of a discussion led by the licensing authority. Cross-examination will be permitted when the Sub Committee considers it to be required. The conduct of hearings shall be broadly based, subject to the discretion of the Sub Committee, on the points set out below.
3. At the start of the hearing the Chairman of the Sub Committee will introduce him/herself and other Members of the Sub Committee as well as the City Corporation officers present. Anyone making representations will then be asked to introduce themselves and anyone accompanying them. The applicant will then do likewise.¹
4. The Chairman will then explain the purpose of the hearing and the procedure to be followed at the hearing. The Sub Committee will then make any rulings necessary in respect of requests for witnesses to be heard in support of any of the parties making representations or the applicant.
5. Those making representations will then be invited to present their case. Repetition will not be permitted. Equal time will be offered to the applicant and those making representations. Where there is more than one party making representations and/or calling witnesses in support, consideration should be given to having one spokesman on behalf of all parties so as to avoid repetition. Although the use of a spokesman will be encouraged by the Sub Committee, the decision rests with those parties making representations.
6. In the event of disorder or persistent disregard of the authority of the Chair, the Chairman may suspend or adjourn the hearing, or require that the person(s) causing disorder or showing disregard leave the hearing.
7. In the event that the Sub Committee has decided that cross-examination will be permitted, the applicant will be invited to ask questions of the party(s) making representations and their witnesses (if any). The party(s) making representations and any witnesses giving evidence in support will then answer any questions put to them by members of the Sub Committee.
8. The applicant will then be invited to present their case and call any witnesses in support of their application. The applicant will be entitled to the same period of time to present his case as those making representations were afforded.

¹ In hearings where a licence is being reviewed, references in this procedure to ‘applicant’ should be read as references to the licence holder and references to ‘those making representations’ should be read as references to those applying for the review.

9. In the event that the Sub Committee has decided that cross-examination will be permitted, those making representations will be invited to ask questions of the applicant and their witnesses (if any). The applicant and any witnesses giving evidence in support will then answer any questions put to them by members of the Sub Committee.
10. The Chairman will ask all parties if there is anything else they would like to add in support of their respective cases.
11. Those making representations will then be invited to make closing submissions followed by the applicant.
12. The Sub Committee will then retire to consider their decision. They may call for assistance by the representatives of the Town Clerk and/or the Comptroller & City Solicitor but those persons will play no part in the decision-making process.
13. In due course, the Sub Committee will return to announce their decision or to inform those present when the decision will be given.

Committee(s): Licensing Sub-Committee	Hearing Date(s): 15 Jul 2016	Item no.
Subject: Licensing Act 2003 - Public Hearing in Respect of an Application for the Variation of a Premises Licence		
Name of Premises: Coppa Club Address of Premises: 4 St Paul's Churchyard, EC4M 8AY		
Report of: Director of Markets and Consumer Protection	Public / Non-Public	
Ward (if appropriate): Bread Street		

1 Introduction

- 1.1 To consider and determine, by public hearing, the application to vary a premises licence under the Licensing Act 2003, taking into account the representation of other persons detailed in paragraph 5 and the policy considerations detailed in paragraph 6 of this report.

- 1.2 The decision of the Sub-Committee must be made with a view to promoting one or more of the four licensing objectives, namely:
 - the prevention of crime and disorder
 - public safety
 - the prevention of public nuisance
 - the protection of children from harm

2 Summary of Application

- 2.1 An application made by:
Strada Trading Ltd
4 St Paul's Churchyard
EC4M 8AY

was received by the City of London Licensing Authority on 19 April 2016 to vary a premises licence in respect of the premises:

Coppa Club
 4 St Paul's Churchyard
 EC4M 8AY

2.2 The application seeks to extend the terminal hour for the sale of alcohol to 02:00 Monday to Sunday.

<u>Activity</u>	<u>Current Licence</u>	<u>Proposed Licence</u>
Sale of Alcohol	Mon-Sat 10:00 – 00:00 Sun 12:00 – 23:30	Mon-Sat 10:00 – 02:00 Sun 12:00 – 02:00
Recorded Music	No Restrictions	No Change
Late Night Refreshment	Mon-Sun 23:00 – 05:00	No Change

The application is also looking to remove the following conditions:

- 1 and 1a – primarily restricting the permitted hours for the sale of alcohol to 23:00 unless taking a table meal
- 2 – Restricting access to the premises of children under fourteen years of age
- 3 – Placing a restriction on payment of sales of alcohol at the time of supply unless paid for with a meal

The sale of alcohol is for both on and off sales.

2.3 The Operating Schedule submitted by the applicant does not suggest any further conditions than those already attached to the current premises licence.

2.5 Full details of the application are contained in a copy of the Application Form at Appendix 1.

3 Licensing History of Premises

- 3.1 A justices' licence was converted in 2005 to the licence holder Signature and Strada Restaurants Ltd. This licence was transferred in September 2014 to the current licence holder, Strada Trading Ltd.
- 3.2 The current premise licence can be seen as Appendix 2.

4 Representations from Responsible Authorities

- 4.1 There have been no representations from responsible authorities.
- 4.2 However, the applicant has agreed with the City of London Police to include the 'no promoted events' condition within their application's operating schedule. This is now a condition that is consistent with the operating schedule and would have been included on the varied licence. A copy of the Police request and subsequent agreement can be seen as Appendix 3.

5 Representations From Other Persons

- 5.1 There have been two representations from other persons. Both representations are against the granting of the variation on the grounds that if granted, it will create excessive noise thus undermining the licensing objective of 'the prevention of public nuisance'.
- 5.2 The representations can be seen in full as appendix 4(i) and 4(ii).

6 Policy Considerations

- 6.1 In carrying out its licensing functions, the Licensing Authority must have regard to its Statement of Licensing policy and any statutory guidance issued under s 182 of the Licensing Act 2003.

City of London Corporation's Statement of Licensing Policy

- 6.2 The following sections/paragraphs of the City of London Corporation's Statement of Licensing Policy are particularly applicable to this application.

Paragraph 29 states that in completing the operating schedule, applicants should set out in some detail how they intend to run the premises in order to promote the four licensing objectives.

Paragraph 50 states an overriding policy principle namely, that each application will be decided on its individual merits, with the process complying with the regulations made under the Licensing Act 2003.

Paragraphs 51-54 state the Corporation's policy on setting conditions which may be applicable dependant on the step(s) taken by members as stated in paragraph nine of this report.

Paragraph 59 - addresses the need to strike a fair balance between the desires and expectations of operators and the benefits to the community of licensed venues with the reasonable expectations of local residents and workers not to be disturbed during night time hours.

Paragraph 66 introduces a number of relevant matters to be considered by the City Corporation when assessing the likelihood of a particular licensable activity causing an unacceptable adverse impact, particularly on local residents and businesses.

Paragraph 84 states that it is the policy of the City Corporation to consider very carefully the implications of granting a licence when the hours sought extend into the early hours of the morning.

Statutory Guidance

- 6.3 The following sections/paragraphs of the statutory guidance issued under s182 of the Licensing Act 2003 are particularly applicable to this application (revised March 2015):

Chapter 2 of the guidance covers the four licensing objectives. In particular, paragraph 2.14 states that it is, '...important that in considering the promotion of [*the public nuisance licensing objective, licensing authorities*] focus on the effect of the licensable activities at the specific premises on persons living and working (including those carrying on business) in the area around the premises which may be disproportionate and unreasonable.' Also, paragraph 2.15 indicates that the prevention of public nuisance could, in appropriate circumstances

include, ‘the reduction of the living and working amenity and environment of other persons living and working in the area of the licensed premises.’

Chapter 10 refers to conditions attached to premises licences with paragraph 10.10 stating that, ‘Conditions should be determined on a case-by-case basis and standard conditions which ignore these individual aspects should be avoided.’ Also, ‘Licensing authorities should therefore ensure that any conditions they impose are only those which are appropriate for the promotion of the licensing objectives.’

7 Map and Plans

- 7.1 A map showing the location of the premises together with nearby licensed premises is attached at Appendix 5. A key of those premises is included which indicates the maximum permitted hours for alcohol sales in respect of each premises.
- 7.2 A copy of the current plans can be seen as Appendix 6.

8 Summary

- 8.1 The Licensing Authority has a duty under the Licensing Act 2003 to promote the Licensing Objectives. Each objective has equal importance. In carrying out its licensing functions, the Licensing Authority must also have regard to its Statement of Licensing Policy, any Statutory Guidance under the Licensing Act 2003 and is bound by the Human Rights Act 1998. The Corporation must also fulfil its obligations under section 17 of the Crime and Disorder Act 1998 to do all that it reasonably can to prevent crime and disorder in the City.

9 Options

- 9.1 The Sub-committee must, having regard to the representation, take such of the following steps as it considers appropriate and necessary for the promotion of the licensing objectives:
 - i) modify the conditions of the licence; or
 - ii) reject the whole or part of the application

Any determination by the licensing sub-committee will not have effect until the end of 21 days following notification of the decision to the applicant by the licensing authority or, in the event of an appeal to the

Magistrates' Court against the Sub-Committee's decision, the determination of the appeal.

For the purposes of paragraph 9.1(i) conditions are modified if any of them are altered or omitted or any new condition is added.

10 Recommendation

10.1 It is therefore RECOMMENDED that your Sub-Committee determine this application for a variation of a premises licence in accordance with paragraph 9 of this report.

Prepared by P Davenport, Licensing Manager
peter.davenport@cityoflondon.gov.uk

Background Papers

<u>BACKGROUND PAPER</u>	<u>DEPT</u>	<u>FILE</u>
Corporation of London Statement of Licensing Policy (revised Jan 2013)	MCP	5th Floor Walbrook Wharf
Statutory Guidance – 'Revised Guidance Issued Under Section 182 Of The Licensing Act 2003'. March 2015		Statutory Guidance

Application to vary a premises licence under the Licensing Act 2003

PLEASE READ THE FOLLOWING INSTRUCTIONS FIRST

Before completing this form please read the guidance notes at the end of the form. If you are completing this form by hand please write legibly in block capitals. In all cases ensure that your answers are inside the boxes and written in black ink. Use additional sheets if necessary.

You may wish to keep a copy of the completed form for your records.

I/We Strada Strading Limited

(Insert name(s) of applicant)

being the premises licence holder, apply to vary a premises licence under section 34 of the Licensing Act 2003 for the premises described in Part 1 below

Premises licence number LN/200500007
--

Part 1 – Premises Details

Postal address of premises or, if none, ordnance survey map reference or description Coppa Club 4 St Paul's Churchyard			
Post town	London	Postcode	EC4M 8AY

Telephone number at premises (if any)	
Non-domestic rateable value of premises	£124,000

Part 2 – Applicant details

Daytime contact telephone number			
E-mail address (optional)			
Current postal address if different from premises address			
Post town		Postcode	

Part 3 - Variation

Please tick as appropriate

Do you want the proposed variation to have effect as soon as possible?

Yes

No

If not, from what date do you want the variation to take effect?

DD	MM	YYYY

Do you want the proposed variation to have effect in relation to the introduction of the late night levy?
(Please see Guidance Note 1)

Yes

No

Please describe briefly the nature of the proposed variation (Please see guidance note 2)

Variation is to:

PART A

Extend the permitted hours for the sale of alcohol until 02:00 Monday to Sunday

PART B

Remove conditions 1 and 1a, referring to the permitted hours for the sale of alcohol and restricting the sale of alcohol after 23:00 to those taking a table meal.

Remove condition 2, restricting access to the premises to children under 14.

Remove condition 3, relating to credit sales.

These conditions are no longer considered necessary or proportionate for the promotion of the licensing objectives.

If your proposed variation would mean that 5,000 or more people are expected to attend the premises at any one time, please state the number expected to attend:

Part 4 Operating Schedule

Please complete those parts of the Operating Schedule below which would be subject to change if this application to vary is successful.

Provision of regulated entertainment

Please tick all that apply

- a) plays (if ticking yes, fill in box A)
- b) films (if ticking yes, fill in box B)
- c) indoor sporting events (if ticking yes, fill in box C)
- d) boxing or wrestling entertainment (if ticking yes, fill in box D)
- e) live music (if ticking yes, fill in box E)
- f) recorded music (if ticking yes, fill in box F)
- g) performances of dance (if ticking yes, fill in box G)
- h) anything of a similar description to that falling within (e), (f) or (g)
(if ticking yes, fill in box H)

Provision of late night refreshment (if ticking yes, fill in box I)

Sale by retail of alcohol (if ticking yes, fill in box J)

In all cases complete boxes K, L and M

A

Plays Standard days and timings (please read guidance note 7)			<u>Will the performance of a play take place indoors or outdoors or both – please tick</u> (please read guidance note 3)	Indoors	<input type="checkbox"/>			
				Outdoors	<input type="checkbox"/>			
				Both	<input type="checkbox"/>			
Day	Start	Finish	<u>Please give further details here</u> (please read guidance note 4)					
Mon								
Tue								
Wed						<u>State any seasonal variations for performing plays</u> (please read guidance note 5)		
Thur								
Fri						<u>Non standard timings. Where you intend to use the premises for the performance of plays at different times to those listed in the column on the left, please list</u> (please read guidance note 6)		
Sat								
Sun								

B

Films Standard days and timings (please read guidance note 7)			<u>Will the exhibition of films take place indoors or outdoors or both – please tick</u> (please read guidance note 3)	Indoors	<input type="checkbox"/>			
				Outdoors	<input type="checkbox"/>			
				Both	<input type="checkbox"/>			
Day	Start	Finish	<u>Please give further details here</u> (please read guidance note 4)					
Mon								
Tue								
Wed						<u>State any seasonal variations for the exhibition of films</u> (please read guidance note 5)		
Thur								
Fri						<u>Non standard timings. Where you intend to use the premises for the exhibition of films at different times to those listed in the column on the left, please list</u> (please read guidance note 6)		
Sat								
Sun								

C

Indoor sporting events Standard days and timings (please read guidance note 7)			<u>Please give further details</u> (please read guidance note 4)
Day	Start	Finish	
Mon			<u>State any seasonal variations for indoor sporting events</u> (please read guidance note 5)
Tue			
Wed			
Thur			<u>Non standard timings. Where you intend to use the premises for indoor sporting events at different times to those listed in the column on the left, please list</u> (please read guidance note 6)
Fri			
Sat			
Sun			

D

Boxing or wrestling entertainments Standard days and timings (please read guidance note 7)			<u>Will the boxing or wrestling entertainment take place indoors or outdoors or both – please tick</u> (please read guidance note 3)	Indoors	<input type="checkbox"/>			
				Outdoors	<input type="checkbox"/>			
				Both	<input type="checkbox"/>			
Day	Start	Finish	<u>Please give further details here</u> (please read guidance note 4)					
Mon								
Tue								
Wed						<u>State any seasonal variations for boxing or wrestling entertainment</u> (please read guidance note 5)		
Thur								
Fri						<u>Non standard timings. Where you intend to use the premises for boxing or wrestling entertainment at different times to those listed in the column on the left, please list</u> (please read guidance note 6)		
Sat								
Sun								

E

Live music Standard days and timings (please read guidance note 7)			<u>Will the performance of live music take place indoors or outdoors or both – please tick</u> (please read guidance note 3)	Indoors	<input type="checkbox"/>			
				Outdoors	<input type="checkbox"/>			
				Both	<input type="checkbox"/>			
Day	Start	Finish	<u>Please give further details here</u> (please read guidance note 4)					
Mon								
Tue								
Wed						<u>State any seasonal variations for the performance of live music</u> (please read guidance note 5)		
Thur								
Fri						<u>Non standard timings. Where you intend to use the premises for the performance of live music at different times to those listed in the column on the left, please list</u> (please read guidance note 6)		
Sat								
Sun								

F

Recorded music Standard days and timings (please read guidance note 7)			<u>Will the playing of recorded music take place indoors or outdoors or both – please tick (please read guidance note 3)</u>	Indoors	<input type="checkbox"/>
				Outdoors	<input type="checkbox"/>
				Both	<input type="checkbox"/>
Day	Start	Finish	<u>Please give further details here (please read guidance note 4)</u> <u>State any seasonal variations for the playing of recorded music (please read guidance note 5)</u> <u>Non standard timings. Where you intend to use the premises for the playing of recorded music at different times to those listed in the column on the left, please list (please read guidance note 6)</u>		
Mon					
Tue					
Wed					
Thur					
Fri					
Sat					
Sun					

G

Performances of dance Standard days and timings (please read guidance note 7)			<u>Will the performance of dance take place indoors or outdoors or both – please tick</u> (please read guidance note 3)	Indoors	<input type="checkbox"/>			
				Outdoors	<input type="checkbox"/>			
				Both	<input type="checkbox"/>			
Day	Start	Finish	<u>Please give further details here</u> (please read guidance note 4)					
Mon								
Tue								
Wed						<u>State any seasonal variations for the performance of dance</u> (please read guidance note 5)		
Thur								
Fri						<u>Non standard timings. Where you intend to use the premises for the performance of dance at different times to those listed in the column on the left, please list</u> (please read guidance note 6)		
Sat								
Sun								

H

Anything of a similar description to that falling within (e), (f) or (g) Standard days and timings (please read guidance note 7)			Please give a description of the type of entertainment you will be providing		
Day	Start	Finish	<u>Will this entertainment take place indoors or outdoors or both – please tick</u> (please read guidance note 3)	Indoors	<input type="checkbox"/>
Mon				Outdoors	<input type="checkbox"/>
				Both	<input type="checkbox"/>
Tue			<u>Please give further details here</u> (please read guidance note 4)		
Wed					
Thur			<u>State any seasonal variations for entertainment of a similar description to that falling within (e), (f) or (g)</u> (please read guidance note 5)		
Fri					
Sat			<u>Non standard timings. Where you intend to use the premises for the entertainment of a similar description to that falling within (e), (f) or (g) at different times to those listed in the column on the left, please list</u> (please read guidance note 6)		
Sun					

Late night refreshment Standard days and timings (please read guidance note 7)			<u>Will the provision of late night refreshment take place indoors or outdoors or both – please tick</u> (please read guidance note 3)	Indoors	<input type="checkbox"/>			
				Outdoors	<input type="checkbox"/>			
				Both	<input type="checkbox"/>			
Day	Start	Finish	<u>Please give further details here</u> (please read guidance note 4) To remain as currently permitted.					
Mon								
Tue								
Wed						<u>State any seasonal variations for the provision of late night refreshment</u> (please read guidance note 5)		
Thur								
Fri						<u>Non standard timings. Where you intend to use the premises for the provision of late night refreshment at different times, to those listed in the column on the left, please list</u> (please read guidance note 6)		
Sat								
Sun								

J

Supply of alcohol Standard days and timings (please read guidance note 7)			Will the supply of alcohol be for consumption – please tick (please read guidance note 6)	On the premises	<input type="checkbox"/>
				Off the premises	<input type="checkbox"/>
				Both	<input checked="" type="checkbox"/>
Day	Start	Finish	State any seasonal variations for the supply of alcohol (please read guidance note 5)		
Mon	1000	0200			
Tue	1000	0200			
Wed	1000	0200			
Thur	1000	0200			
Fri	1000	0200			
Sat	1000	0200			
Sun	1200	0200			
			Non-standard timings. Where you intend to use the premises for the supply of alcohol at different times to those listed in the column on the left, please list (please read guidance note 6)		

K

<p>Please highlight any adult entertainment or services, activities, other entertainment or matters ancillary to the use of the premises that may give rise to concern in respect of children (please read guidance note 9).</p> <p>None</p>

L

Hours premises are open to the public Standard days and timings (please read guidance note 7)			State any seasonal variations (please read guidance note 5)
Day	Start	Finish	
Mon	0700	0230	
Tue	0700	0230	
Wed	0700	0230	
Thur	0700	0230	
Fri	0700	0230	
Sat	0700	0230	
Sun	0700	0230	Non standard timings. Where you intend the premises to be open to the public at different times from those listed in the column on the left, please list (please read guidance note 6)

Please identify those conditions currently imposed on the licence which you believe could be removed as a consequence of the proposed variation you are seeking.
 Annex 2 - conditions 1, 1a, 2, and 3.

Please tick as appropriate

- I have enclosed the premises licence
- I have enclosed the relevant part of the premises licence

If you have not ticked one of these boxes, please fill in reasons for not including the licence or part of it below

Reasons why I have not enclosed the premises licence or relevant part of premises licence.

M

Describe any additional steps you intend to take to promote the four licensing objectives as a result of the proposed variation:

a) General – all four licensing objectives (b, c, d and e) (please read guidance note 10)

The remaining conditions currently attached to the premises licence promote the licensing objectives, and will continue to have effect should the variation be permitted.

b) The prevention of crime and disorder

please refer to box a) above

c) Public safety

please refer to box a) above

d) The prevention of public nuisance

please refer to box a) above

e) The protection of children from harm

please refer to box a) above

Checklist:

Please tick to indicate agreement

- I have made or enclosed payment of the fee.
- I have sent copies of this application and the plan to responsible authorities and others where applicable. – N/A SUBMITTED ONLINE
- I understand that I must now advertise my application.
- I have enclosed the premises licence or relevant part of it or explanation.
- I understand that if I do not comply with the above requirements my application will be rejected.

IT IS AN OFFENCE, LIABLE ON SUMMARY CONVICTION TO A FINE NOT EXCEEDING LEVEL 5 ON THE STANDARD SCALE, UNDER SECTION 158 OF THE LICENSING ACT 2003, TO MAKE A FALSE STATEMENT IN OR IN CONNECTION WITH THIS APPLICATION.

Part 5 – Signatures (please read guidance note 11)

Signature of applicant (the current premises licence holder) or applicant’s solicitor or other duly authorised agent (please read guidance note 12). **If signing on behalf of the applicant, please state in what capacity.**

Signature	[REDACTED]
Date	19/04/2016
Capacity	Thomas & Thomas Partners LLP, Solicitors on behalf fo the applicant

Where the premises licence is jointly held, signature of 2nd applicant (the current premises licence holder) or 2nd applicant’s solicitor or other authorised agent (please read guidance note 13). **If signing on behalf of the applicant, please state in what capacity.**

Signature	
Date	
Capacity	

Contact name (where not previously given) and address for correspondence associated with this application (please read guidance note 14) Amy Catlin (STR.25.30) Thomas & Thomas Partners LLP [REDACTED] Monmouth Street			
Post town	London	Post code	WC2H 9EP
Telephone number (if any)	[REDACTED]		
If you would prefer us to correspond with you by e-mail, your e-mail address (optional) [REDACTED]			

Notes for Guidance

This application cannot be used to vary the licence so as to extend the period for which the licence has effect or to vary substantially the premises to which it relates. If you wish to make that type of change to the premises licence, you should make a new premises licence application under section 17 of the Licensing Act 2003.

1. You do not have to pay a fee if the only purpose of the variation for which you are applying is to avoid becoming liable to the late night levy.
2. Describe the premises. For example the type of premises, its general situation and layout and any other information which could be relevant to the licensing objectives. Where your application includes off-supplies of alcohol and you intend to provide a place for consumption of these off-supplies, you must include a description of where the place will be and its proximity to the premises.
3. Where taking place in a building or other structure please tick as appropriate (indoors may include a tent).
4. For example state type of activity to be authorised, if not already stated, and give relevant further details, for example (but not exclusively) whether or not music will be amplified or unamplified.
5. For example (but not exclusively), where the activity will occur on additional days during the summer months.
6. For example (but not exclusively), where you wish the activity to go on longer on a particular day e.g. Christmas Eve.
7. Please give timings in 24 hour clock (e.g. 16:00) and only give details for the days of the week when you intend the premises to be used for the activity.
8. If you wish people to be able to consume alcohol on the premises, please tick 'on the premises'. If you wish people to be able to purchase alcohol to consume away from the premises, please tick 'off the premises'. If you wish people to be able to do both, please tick 'both'.
9. Please give information about anything intended to occur at the premises or ancillary to the use of the premises which may give rise to concern in respect of children regardless of whether you intend children to have access to the premises, for example (but not exclusively) nudity or semi-nudity, films for restricted age groups or the presence of gaming machines.
10. Please list here steps you will take to promote all four licensing objectives together.
11. The application form must be signed.
12. An applicant's agent (for example solicitor) may sign the form on their behalf provided that they have actual authority to do so.
13. Where there is more than one applicant, each of the applicants or their respective agents must sign the application form.
14. This is the address which we shall use to correspond with you about this application.



**Licensing Act 2003
Section 24
Premises licence**

Trading Standards (Licensing Section), City of London
PO Box 270 Guildhall, London EC2P 2EJ

Premises licence number

LN/200500007

Part 1 - Premises details

Postal address of premises, or if none, ordnance survey map reference or description	
Strada, 4 St Paul's Churchyard	
Post town London	Post code EC4M 8AY
Telephone Number 020 7248 7178	

Where the licence is time limited - the dates

Licensable activities authorised by the licence

Alcohol Sales, Recorded Music, Late Night Refreshment

The times the licence authorises the carrying out of licensable activities

Alcohol Sales

Sunday	12:00 - 23:30	-
Monday	10:00 - 00:00	-
Tuesday	10:00 - 00:00	-
Wednesday	10:00 - 00:00	-
Thursday	10:00 - 00:00	-
Friday	10:00 - 00:00	-
Saturday	10:00 - 00:00	-

The above terminal hour is subject to Licence Condition 1(a)

Late Night Refreshment

Sunday	23:00 - 05:00	-
Monday	23:00 - 05:00	-
Tuesday	23:00 - 05:00	-
Wednesday	23:00 - 05:00	-
Thursday	23:00 - 05:00	-
Friday	23:00 - 05:00	-
Saturday	23:00 - 05:00	-

There are no restrictions on the times permitted for Recorded Music

The opening hours of the premises

Opening Hours

Sunday	-	-
Monday	-	-
Tuesday	-	-
Wednesday	-	-
Thursday	-	-
Friday	-	-
Saturday	-	-

There are no restrictions on the Opening Hours under this licence

Where the licence authorises supplies of alcohol - whether these are on and/or off supplies

On & Off the Premises

Part 2

Name, (registered) address, telephone number and email (where relevant) of holder of premises licence

Strada Trading Limited
Fifth Floor
■ Charlotte Street
London
W1T 1RR

Registered number of holder, for example company number, charity number (where applicable)

■

Name, address and telephone number of designated premises supervisor where the premises licence authorises for the supply of alcohol

Marius Pranauskas
■ Kilmarsh Road
Hammersmith
London
W6 0PL

Personal licence number and issuing authority of personal licence held by designated premises supervisor – where the premises licence authorises for the supply of alcohol

■ – City of Westminster

Date granted 15th April 2005

Latest Amendment 13th January 2016

■
Director of Environmental Services

Alcohol

1. No supply of alcohol may be made under the Premises Licence –
 - (a) At a time when there is no Designated Premises Supervisor in respect of the Premises Licence; or
 - (b) At a time when the Designated Premises Supervisor does not hold a Personal Licence or his Personal Licence is suspended.
2. Every supply of alcohol under the Premises Licence must be made, or authorised by a person who holds a Personal Licence.
3. (1) The responsible person must ensure that staff on relevant premises do not carry out, arrange or participate in any irresponsible promotions in relation to the premises.
 - (2) In this paragraph, an irresponsible promotion means any one or more of the following activities, or substantially similar activities, carried on for the purpose of encouraging the sale or supply of alcohol for consumption on the premises.
 - a) games or other activities which require or encourage, or are designed to require or encourage, individuals to –
 - (i) drink a quantity of alcohol within a time limit (other than to drink alcohol sold or supplied on the premises before the cessation of the period in which the responsible person is authorised to sell or supply alcohol), or
 - (ii) drink as much alcohol as possible (whether within a time limit or otherwise);
 - b) provision of unlimited or unspecified quantities of alcohol free or for a fixed or discounted fee to the public or to a group defined by a particular characteristic in a manner which carries a significant risk of undermining a licensing objective;
 - c) provision of free or discounted alcohol or any other thing as a prize to encourage or reward the purchase and consumption of alcohol over a period of 24 hours or less in a manner which carries a significant risk of undermining a licensing objective;
 - d) selling or supplying alcohol in association with promotional posters or flyers on, or in the vicinity of, the premises which can reasonably be considered to condone, encourage or glamorise anti-social behaviour or to refer to the effects of drunkenness in any favourable manner.
 - e) dispensing alcohol directly by one person into the mouth of another (other than where that other person is unable to drink without assistance by reason of disability).
4. The responsible person must ensure that free potable water is provided on request to customers where it is reasonably available.
5. (1) The premises licence holder or club premises certificate holder must ensure that an age verification policy is adopted in respect of the premises in relation to the sale or supply of alcohol.
 - (2) The designated premises supervisor in relation to the premises licences must ensure that the supply of alcohol at the premises is carried on in accordance with the age verification policy.

(3) The policy must require individuals who appear to the responsible person to be under 18 years of age (or such older age as may be specified in the policy) to produce on request, before being served alcohol, identification bearing their photograph, date of birth and either:-

(a) a holographic mark or

(b) an ultraviolet feature.

6. The responsible person shall ensure that –

(a) where any of the following alcoholic drinks is sold or supplied for consumption on the premises (other than alcoholic drinks sold or supplied having been made up in advance ready for sale or supply in a securely closed container) it is available to customers in the following measures –

(i) beer or cider: ½ pint;

(ii) gin, rum, vodka or whisky: 25 ml or 35 ml; and

(iii) still wine in a glass: 125 ml; and

(b) these measures are displayed in a menu, price list or other printed material which is available to customers on the premises; and

(c) where a customer does not in relation to a sale of alcohol specify the quantity of alcohol to be sold, the customer is made aware that these measures are available.

Minimum Drinks Pricing

1. A relevant person shall ensure that no alcohol is sold or supplied for consumption on or off the premises for a price which is less than the permitted price.

2. For the purposes of the condition set out in paragraph 1 –

(a) “duty” is to be construed in accordance with the Alcoholic Liquor Duties Act 1979

(b) “permitted price” is the price found by applying the formula –

$$P = D + (D \times V)$$

Where –

(i) P is the permitted price

(ii) D is the amount of duty chargeable in relation to the alcohol as if the duty were charged on the date of the sale or supply of the alcohol, and

(iii) V is the rate of value added tax chargeable in relation to the alcohol as if the value added tax were charged on the date of the sale or supply of the alcohol;

(c) “relevant person” means, in relation to premises in respect of which there is in force a premises licence –

(i) The holder of the premises licence

(ii) The designated premises supervisor (if any) in respect of such a licence, or

(iii) The personal licence holder who makes or authorises a supply of alcohol under such a licence;

- (d) "relevant person" means, in relation to premises in respect of which there is in force a club premises certificate, any member or officer of the club present on the premises in a capacity which enables the member or officer to prevent the supply in question; and
 - (e) "value added tax" means value added tax charged in accordance with the Value Added Tax Act 1994.
- 3. Where the permitted price given by Paragraph (b) of paragraph 2 would (apart from the paragraph) not be a whole number of pennies, the price given by that sub-paragraph shall be taken to be the price actually given by that sub-paragraph rounded up to the nearest penny.
 - 4. (1) Sub-paragraph (2) applies where the permitted price given by Paragraph (b) of paragraph 2 on a day ("the first day") would be different from the permitted price on the next day ("the second day") as a result of a change to the rate of duty or value added tax.

(2) The permitted price which would apply on the first day applies to sales or supplies of alcohol which take place before the expiry of the period of 14 days beginning on the second day.

NO: 1

SOURCE: s.59, 60, 63, 67A, 68, 70, 74, 76, LA 1964

TYPES OF PREMISES: On-licences

TYPE OF RESTRICTION: Permitted hours

WORDING OF CONDITION:

Alcohol shall not be sold or supplied except during permitted hours.

In this condition, permitted hours means:

- a. On weekdays, other than Christmas Day, Good Friday, 10 a.m. to 11 p.m.
- b. On Sundays, other than Christmas Day, 12 noon to 10.30 p.m.
- c. On Good Friday, 12 noon to 10.30 p.m.
- d. On Christmas Day, 12 noon to 3 p.m. and 7 p.m. to 10.30 p.m.

The above restrictions do not prohibit:

- (a) Consumption of alcohol on the premises or the taking or sale or supply of alcohol to any person residing in the licensed premises;
- (b) The ordering of alcohol to be consumed off the premises, or the despatch by the vendor of the alcohol so ordered;
- (c) The supply of alcohol for consumption on the premises to any private friends of a person residing there who are bona fide entertained by him at his own expense, or the consumption of alcohol by persons so supplied.

1. (a) Sub-Condition – Supper Hours Certificate – Section 68

Alcohol may be sold or supplied [for one hour following the hours set out above and] to persons taking table meals in the premises in a part of the premises usually set apart for the service of such persons and for consumption by such a person in that part of the premises as an ancillary to his meal. For other purposes or in other parts of the premises the hours set out above shall continue to apply.”

NO: 2

SOURCE: S.168, 171, 201 LA 1964

TYPES OF PREMISES: On-licence, no children’s certificate

TYPE OF RESTRICTION: Children in bars.

WORDING OF CONDITION:

No person under fourteen shall be in the bar of the licensed premises during the permitted hours unless one of the following applies:

- (a) He is the child of the holder of the premises licence.
- (b) He resides in the premises, but is not employed there.
- (c) He is in the bar solely for the purpose of passing to or from some part of the premises which is not a bar and to or from which there is no other convenient means of access or egress.
- (d) The bar is in railway refreshment rooms or other premises constructed, fitted and intended to be used bona fide for any purpose to which the holding of the licence is ancillary. In this condition "bar" includes any place exclusively or mainly used for the consumption of intoxicating liquor. But an area is not a bar when it is usual for it to be, and it is, set apart for the service of table meals and alcohol is only sold or supplied to persons as an ancillary to their table meals.

NO: 3

SOURCE: S.166 LA 1964

TYPES OF PREMISES: On-licence.

TYPE OF RESTRICTION: Credit Sales.

WORDING OF CONDITION:

Alcohol shall not be sold or supplied unless it is paid for before or at the time when it is sold or supplied, except alcohol sold or supplied:

- (a) with and for consumption at a meal supplied at the same time, consumed with the meal and paid for together with the meal.
 - (b) for consumption by a person residing in the premises or his guest and paid for together with his accommodation.
 - (c) to a canteen or a mess.
- 4) Substantial food and non-intoxicating beverages (including drinking water) shall be available during licensing hours in all parts of the premises where liquor is sold.
- 5) All customers seated at tables and chairs will be served by waiter/waitress only.
- 6) Permission is given for the premises to open for all licensed activities from the commencement of trading on New Years Eve until the end of trading on New Years Day save for the sale of alcohol which shall cease at midnight on New Years Eve.
- 7) The premises may be used for the provision of private entertainment as previously permitted under the Private Places of Entertainment (Licensing) Act 1967.

This page is intentionally left blank

Tel: 020 7601 2748
Fax: 020 7332 0119

9th May 2016

Thomas & Thomas
[REDACTED] Monmouth Street
London
WC2H 9EP

Our Ref: GA/196

Dear Sirs,

**Coppa Club, 4 St Pauls Churchyard, London, EC4M 8AY
Variation – Hours and Conditions**

I am directed by the Commissioner to acknowledge your correspondence received online to police on 21st April 2016 and to inform you that Police have a concern that in its current form could undermine the Crime Prevention Objective.

If the application were amended with the following condition proposed, we would be in a position whereby those concerns would be nullified:

No promoted events will be held at the premises. A promoted event is an event involving music and/or dancing where the musical entertainment is provided at any time by a disc jockey or disc jockeys one or some of whom are not employees of the licensee (premises license holder) and/or the event is (independent of the licensee) promoted to the general public.

If you are in agreement please amend the application by e-mailing the officers of the Corporation at licensing@cityoflondon.gov.uk and copy to me. Thank you for your kind consideration.

Yours faithfully,

John Hall.
Licensing Officer

Cc: Principal Licensing Officer, City of London, PO Box 270, Guildhall, London, EC2P 2EJ.

Breese, Robert

From: Amy Catlin [REDACTED]
Sent: 11 May 2016 10:31
To: Hall John
Cc: M&CP - Licensing; Douglas Simon; Holmes Paul; Thomas O'Maoileoin
Subject: RE: Coppa Club, 4 St Pauls Churchyard (NOT PROTECTIVELY MARKED)

Dear John,

Further to your email below, I can confirm that we are happy to agree to your condition in relation to promoted events.

Kind regards,

Amy

Amy Catlin

Licensing Assistant

Thomas & Thomas Partners LLP

D: [REDACTED]

E: [REDACTED]

From: Hall John [mailto:[REDACTED]]
Sent: 09 May 2016 11:12
To: Amy Catlin <[REDACTED]>
Cc: [REDACTED] Douglas Simon [REDACTED] Holmes Paul
Subject: Coppa Club, 4 St Pauls Churchyar (NOT PROTECTIVELY MARKED)
Importance: High

Classification: NOT PROTECTIVELY MARKED

Dear Amy,

Please find attached letter. We have a concern with the extension to hours particularly in that sensitive (geographical) area so have proposed a condition. It is well known to Alan and should not cause a concern to the client. Many thanks and.....

Kind Regards



John Hall
Licensing Officer
[REDACTED]



 THE CHURCH
OF ENGLAND
CHURCH
COMMISSIONERS

City Of London Licencing Authority
Walbrook Wharf
78-83 Upper Thames Street,
London
EC4R 3TD

Mr C. C. Scott
Senior Property Manager
See House Team, Bishoprics &
Cathedrals Department

BY HAND

17th May 2016

Dear Sirs,

Letter of Objection, relating to proposed: Variation of Licencing, relating to:
Strada Trading Ltd – The Coppa Club, 4 St Paul's Churchyard / Ward: Bread Street.

We are the freeholders of the property known and situate as, The Old Deanery, Deans Court, London EC4V 5AA and in such capacity, write to object in the strongest terms to the proposal:

- 1) To permit the sale of alcohol on and off the premises 10am – 2am Monday to Saturday.
12pm – 2am Sunday.

Our reasons for objection are:

1. Late night/early morning drinking without food service.
2. Noise Generation - Our property lies immediately adjacent to the subject premises and in such position, where the rear windows of the subject premises open on to our courtyard, any noise generation is massively magnified, being contained and reverberating between the buildings, thereabouts.
Our property is the residence of the Bishop of London & his family and guests and as such, in this location, they are susceptible to late night noise disturbance, which is particularly anti-social, given the long hours worked and early morning calls to service by the bishop and his staff (including Sundays), to say nothing of his family.
3. Anti-social behaviours and public gathering on steps and forecourt, located immediately next to our entrances.
4. Litter/fouling which will increase in severity and which is already a nuisance with the existing use and licencing hours.
5. Supervision and policing being overstretched in coping with the consequences of drinking alcohol through to early morning hours
6. We also understand, but have not yet been able to check, that the original extension into [redacted] room which opens onto our courtyard was conditional upon the

[redacted] d
Cc: The Lord Bishop of London, Mr O. Caroe, Surveyor to St Paul's Cathedral.

Church House, Great Smith Street, London SW1 3AZ
Direct Line [redacted] Switchboard: +44(0)20 7898 1000
Email: [redacted] DX: 148403 Westminster 5

This page is intentionally left blank

From the Headmaster
Neil Chippington MA, FRCO

Town Clerk,
City of London,
Guildhall,
London,
EC2P 2EJ



9 May 2016

Dear Sir,

**Re: Application for a variation of a premises licence
Coppa Club
4, St Paul's Churchyard EC4M 8AY**

I am writing to oppose this application for a variation of a premises licence. The venue is very close to St Paul's Cathedral School which is a boarding school for the choristers of St Paul's Cathedral who live and work here during term time. There are also a number of members of staff who live here with their families. If the Coppa Club is allowed to sell alcohol off the premises in particular, I imagine that the noise level outside could be considerable until the early hours of the morning. We already have ongoing difficulties with Madison's in One New Change who appear to have a licence to play music outside until the early hours and anything that adds to this in the area around the school will make living here unbearable.

As you will be aware, the choristers of St Paul's are required to sing at major services, including those of national significance, as well as singing the daily round of services in St Paul's Cathedral throughout the year. Their well-being and health is of paramount importance to myself and my staff and we are very concerned about the growing number of bars and clubs in this area which are open until very late at night which undoubtedly has a negative impact.

Yours faithfully,

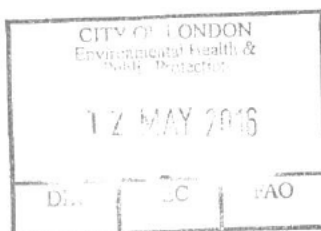
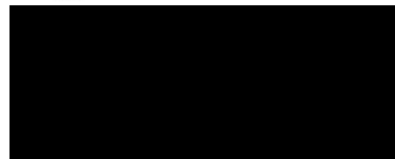

This page is intentionally left blank

Vicinity map for 4 St. Paul's Churchyard

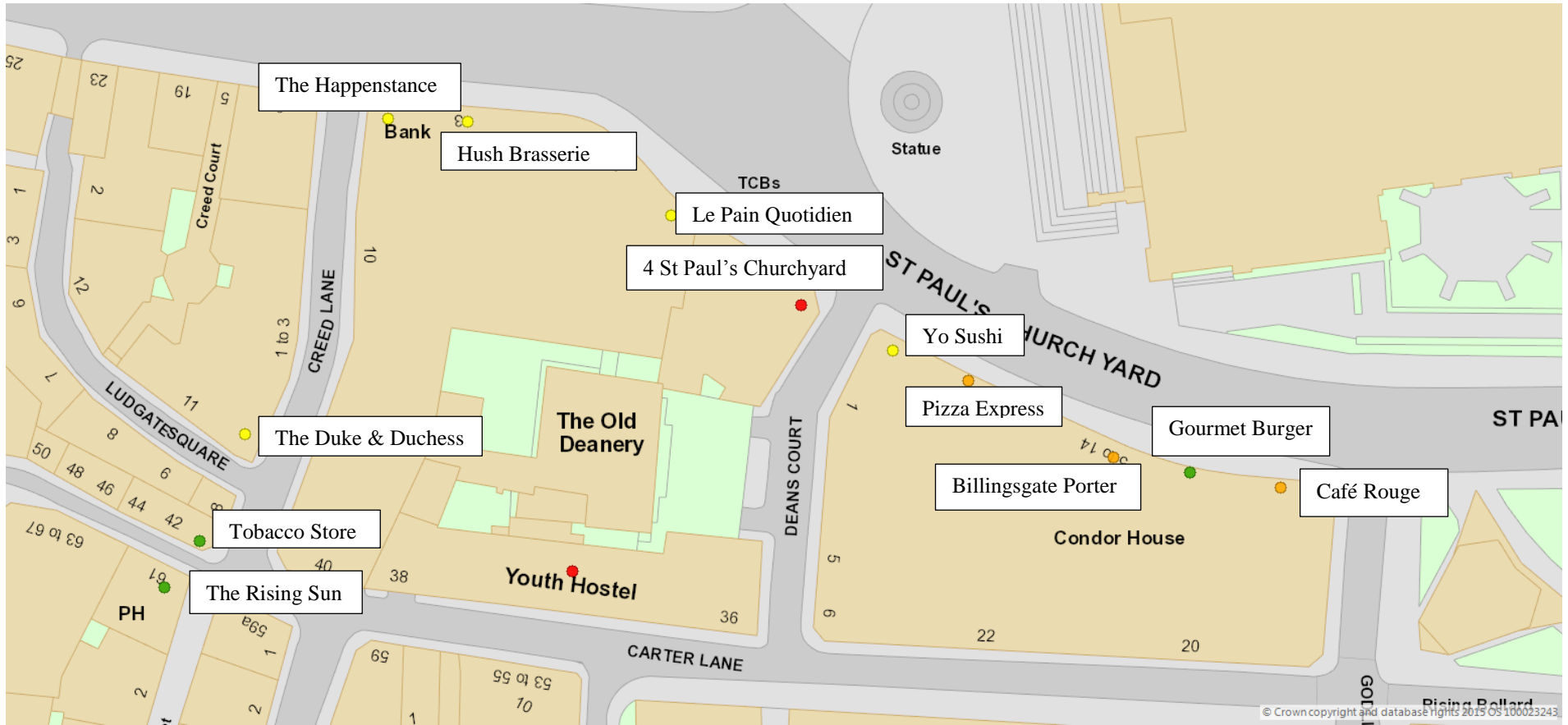

Latest terminal hour for a licensable activity



Up to 23:00



23:01 to 00:00



00:01 to 02:00



02:01 or later

Coppa Club, 4 St Paul's Churchyard, EC4M 8AY

Latest permitted hours for alcohol sales +
later licensable hours if applicable

The Rising Sun	23:00
St. Paul's Tobacco Store	23:00
The Duke And Duchess	00:00
The Happenstance	23:30 (Late Night Refreshment – 00:00)
Hush Brasseries	00:00
Le Pain Quotidien	23:00 (Late Night Refreshment – 23:30)
Yo Sushi	23:00 (Late Night Refreshment – 23:30)
Pizza Express	00:00 (Late Night Refreshment – 00:30)
The Billingsgate Porter	23:45 (Late Night Refreshment – 00:30)
Gourmet Burger	23:00
Café Rouge	00:00 (Late Night Refreshment – 01:00)
Youth Hostel	00:00 (Late Night Refreshment – 05:00)

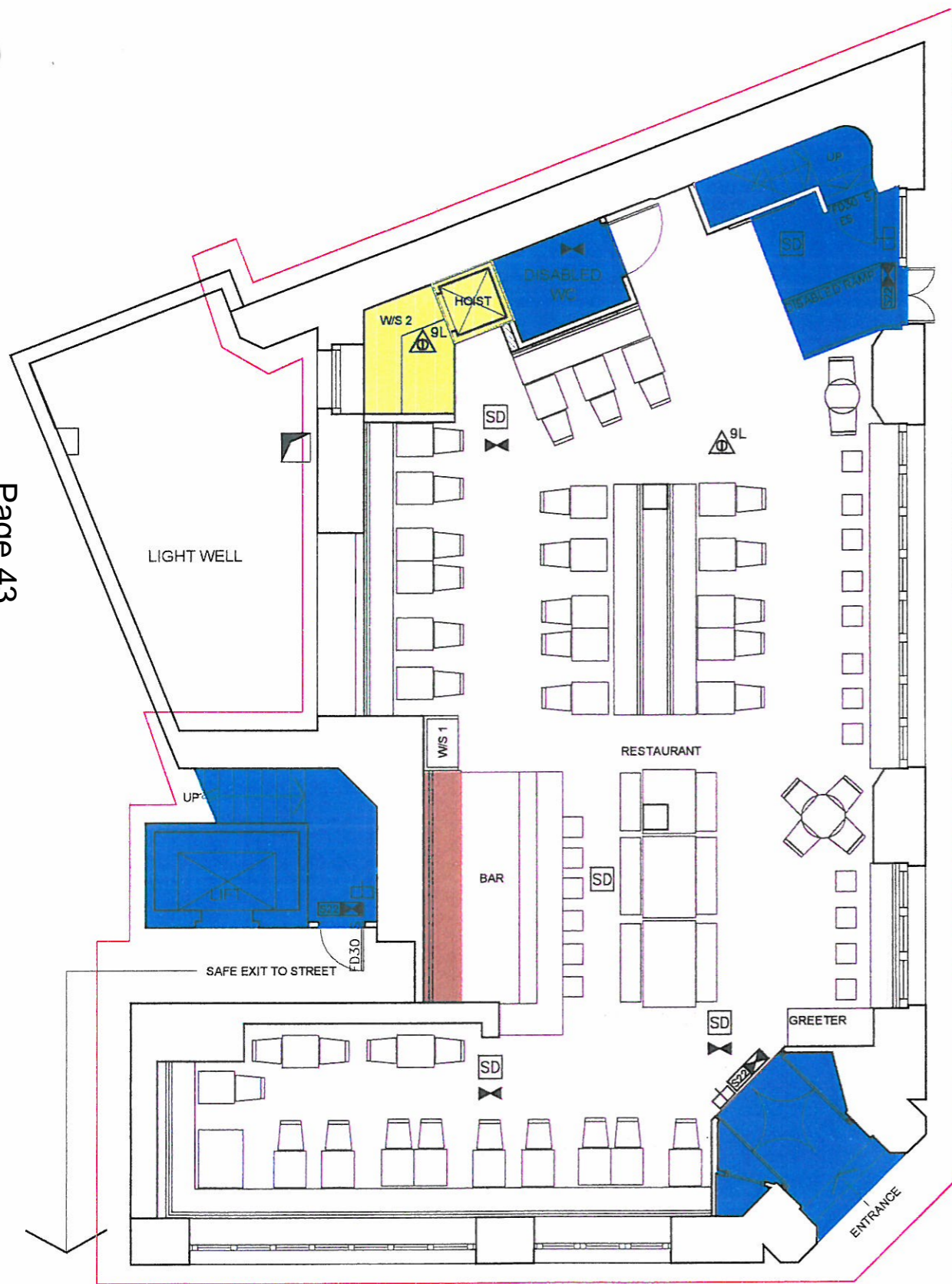

FIRE SAFETY LEGEND

	FIRE ALARM CALL POINT
	9 LITRE WATER FIRE EXTINGUISHER
	2 KG CARBON DIOXIDE EXTINGUISHER (OR HALON)
	9 LITRE FOAM FIRE EXTINGUISHER
	FIRE BLANKET IN CONTAINER
	AREA COVERED BY AUTOMATIC HEAT DETECTORS
	AREA COVERED BY AUTOMATIC SMOKE DETECTORS
	AREA COVERED BY EMERGENCY LIGHTING (BS 5266)
	PANIC BAR TO BE PROVIDED TO DOORS
	DOORS TO HAVE ONLY A SIMPLE FASTENING WITHOUT USE OF A KEY E.G. BARREL BOLT, NIGHT LATCH SIGN, 'FIRE DOOR KEEP SHUT', 5MM LETTERS (BOTH SIDES OF DOOR)
	SIGN, 'FIRE DOOR KEEP SHUT'
	SIGN, 'FIRE DOOR KEEP LOCKED'
	SIGN, 'FIRE ESCAPE KEEP CLEAR'
	SIGN, 'FIRE EXIT' OR GRAPHIC EQUIVALENT 75MM LETTERS
	DIRECTIONAL ARROW TO BE PROVIDED WITH S22 NOTICE
	ILLUMINATED SIGN - 'FIRE EXIT' OR GRAPHIC EQUIVALENT 75MM LETTERS
	FIRE ALARM SOUNDER
	FD30 S 30 MINS FIRE PROTECTED DOOR W/ SMOKE SEALANTS

GENERAL FIRE NOTES

- DOORS THAT ARE REQUIRED TO PROVIDE 30 STANDARD OF FIRE MINUTES RESISTANCE TO BS 476 PART 22.
- GLAZING TO DOORS, TO HAVE 30 MINUTES STANDARD OF FIRE RESISTANCE TO BS 476: PART 22
- ALL DOORS ON ESCAPE ROUTES TO BE FITTED WITH SIMPLE FASTENINGS OPENABLE FROM THE ESCAPE SIDE OPENABLE FROM THE ESCAPE SIDE WITHOUT THE USE OF A KEY.
- ALL EXIT SIGNS MUST COMPLY WITH BS5499: PART 1:1990 19. ALL FIRE DOORS FD.30 TO BE FITTED WITH A 25MM HARDWOOD DOOR CHECK GLUED AND SCREWED TO THE DOOR FRAME
- ALL DEMOLITION TO BE CARRIED OUT IN ACCORDANCE WITH THE HEALTH AND SAFETY AT WORK ET ACT AND BS 6187
- EMERGENCY LIGHTING TO BE PROVIDED IN THE ESCAPE STAIR AND ON A PROTECTED CIRCUIT FROM THAT SUPPLYING ANY OTHER PART OF THE ESCAPE ROUTE. EMERGENCY LIGHTING TO COMPLY WITH BS 5266 PT.1:1988 (MAINTAINED 3 HOURS DURATION)
- FABRIC TO UPHOLSTERED FURNITURE TO MEET IGNITION SOURCE 5 TEST TO COMPLY WITH BS PT.2.1982.
- FIRE WARNING SYSTEM TO COMPLY WITH BS 5839 PT.1:1988
- FIRE FIGHTING EQUIPMENT TO COMPLY WITH BS 5423 PT.1:1987 DURATION)
- FIRE SIGNS AND NOTICES TO COMPLY WITH BS 5499 PT.1:1990
- ALL ILLUMINATED EXIT SIGNS AND EMERGENCY LIGHTING TO BE FULLY MAINTAINED.

As approved by the Fire Officer for fire to have

CITY OF LONDON

PLAN No. ~~6004-L4A~~

APPROVED ON ~~22/10~~

~~REPLANT (PROVISIONAL)~~

MODIFICATIONS s.6 (3)

ALTERATIONS s.20

GSM
 Clerk/Chairman
 Licensing Justices



COVERS

TYPE	QUANTITY
RESTAURANT SEATING	80
CAFE SEATING	20
TOTAL	100 COVERS

WALL LEGEND

SYMBOL	DESCRIPTION
	EXISTING WALL
	NEW FULL HEIGHT CONSTRUCTION 1hr FR & INSULATION
	NEW FULL HEIGHT WALL

AREA - SQM

AREA	SQM
GROUND FLOOR	
RESTAURANT	133
KITCHEN/ STORES	3
PASSAGEWAYS/ WCs	27
TOTAL GROUND FLOOR	163
BASEMENT	
RESTAURANT	0
KITCHEN/ STORES	330
PASSAGEWAYS/ WCs	110
TOTAL BASEMENT	440
TOTAL	603 SQM

LICENSING LEGEND

	DRINKING AREAS (INCL. BARS)
	LIQUOR STORAGE
	KITCHEN AND STAFF AREAS
	WC, PASSAGEWAYS ETC
	AMBIT OF LICENSED PREMISES

REVISIONS

Rev.	Date	Comment
A.	23.06.04	DESIGN REVISION BAR ADDED FURNITURE PLAN CHANGE

- NOTES**
- THE DRAWING SHOW DESIGN INTENT ONLY. ALL DIMENSIONS TO BE CHECKED ON SITE PRIOR TO CONSTRUCTION OR PRODUCTION. CONSTRUCTION DETAILS TO BE CONFIRMED BY CONTRACTOR/MANUFACTURER BY SUBMITTING SHOP DRAWINGS FOR DESIGNER'S APPROVAL.
 - DESIGN / DRAWING IS NOT TO BE SCALED FOR PRODUCTION AND CONSTRUCTION PURPOSES.
 - ALL DISCREPANCIES AND OMISSIONS ON SITE MUST BE REPORTED TO DESIGNER FOR THEIR COMMENTS OR APPROVAL PRIOR TO COMMENCING WORK.
 - ALL ELECTRICAL, LIGHTING, HVAC AND PLUMBING ISSUES TO BE REFERRED TO ENGINEER'S DRAWINGS PRIOR TO COMMENCEMENT OF WORKS.
 - THE DESIGNS ARE SUBJECT TO APPROVAL BY STATUTORY AUTHORITIES AND ANY NECESSARY ALTERATIONS SHOULD BE MADE IF REQUIRED TO COMPLY WITH STATUTORY REQUIREMENTS.
 - ALL DESIGN CONCEPTS AND DRAWINGS ARE THE PROPERTY OF MARTIN BRUDNIZKI AND ARE COVERED BY COPYRIGHT. NO REPRODUCTIONS, ADAPTATIONS AND/OR COPIES MAY BE MADE WITHOUT WRITTEN PERMISSION BY MARTIN BRUDNIZKI.

LICENSING

Project
 No 4 ST PAULS CHURCHYARD

Title
 PLAN PROPOSALS
 PAGE 1 OF 2

Date
 23.06.04

Scale
 1:100@A3

Drwg No
 6004-L4

Rev.
 A

Auto Cad ref

MARTIN BRUDNIZKI
 DESIGN STUDIO LTD
 Unit 2L Chelsea Reach
 79-89 Lots Road London SW10 0RN
 Tel +44 (0)20 7376 7555
 Fax +44 (0)20 7376 7444

FIRE SAFETY LEGEND

- FIRE ALARM CALL POINT
- 9 LITRE WATER FIRE EXTINGUISHER
- 2 KG CARBON DIOXIDE EXTINGUISHER (OR HALON)
- 9 LITRE FOAM FIRE EXTINGUISHER
- FIRE BLANKET IN CONTAINER
- AREA COVERED BY AUTOMATIC HEAT DETECTORS
- AREA COVERED BY AUTOMATIC SMOKE DETECTORS
- AREA COVERED BY EMERGENCY LIGHTING (BS 5265)
- PANIC BAR TO BE PROVIDED TO DOORS
- DOORS TO HAVE ONLY A SIMPLE FASTENING WITHOUT USE OF A KEY. E.G. BARREL BOLT, NIGHT LATCH
- SIGN; 'FIRE DOOR KEEP SHUT', 5MM LETTERS (BOTH SIDES OF DOOR)
- SIGN; 'FIRE DOOR KEEP LOCKED'
- SIGN; 'FIRE ESCAPE KEEP CLEAR'
- SIGN; 'FIRE EXIT' OR GRAPHIC EQUIVALENT 75MM LETTERS
- DIRECTIONAL ARROW TO BE PROVIDED WITH S22 NOTICE
- ILLUMINATED SIGN - 'FIRE EXIT' OR GRAPHIC EQUIVALENT 75MM LETTERS
- FIRE ALARM SOUNDER
- FD30 S 30 MINS FIRE PROTECTED DOOR W/ SMOKE SEALANTS

LICENSING LEGEND

- DRINKING AREAS (INCL. BARS)
- LIQUOR STORAGE
- KITCHEN AND STAFF AREAS
- WC, PASSAGEWAYS ETC
- AMBIT OF LICENSED PREMISES



Page 44

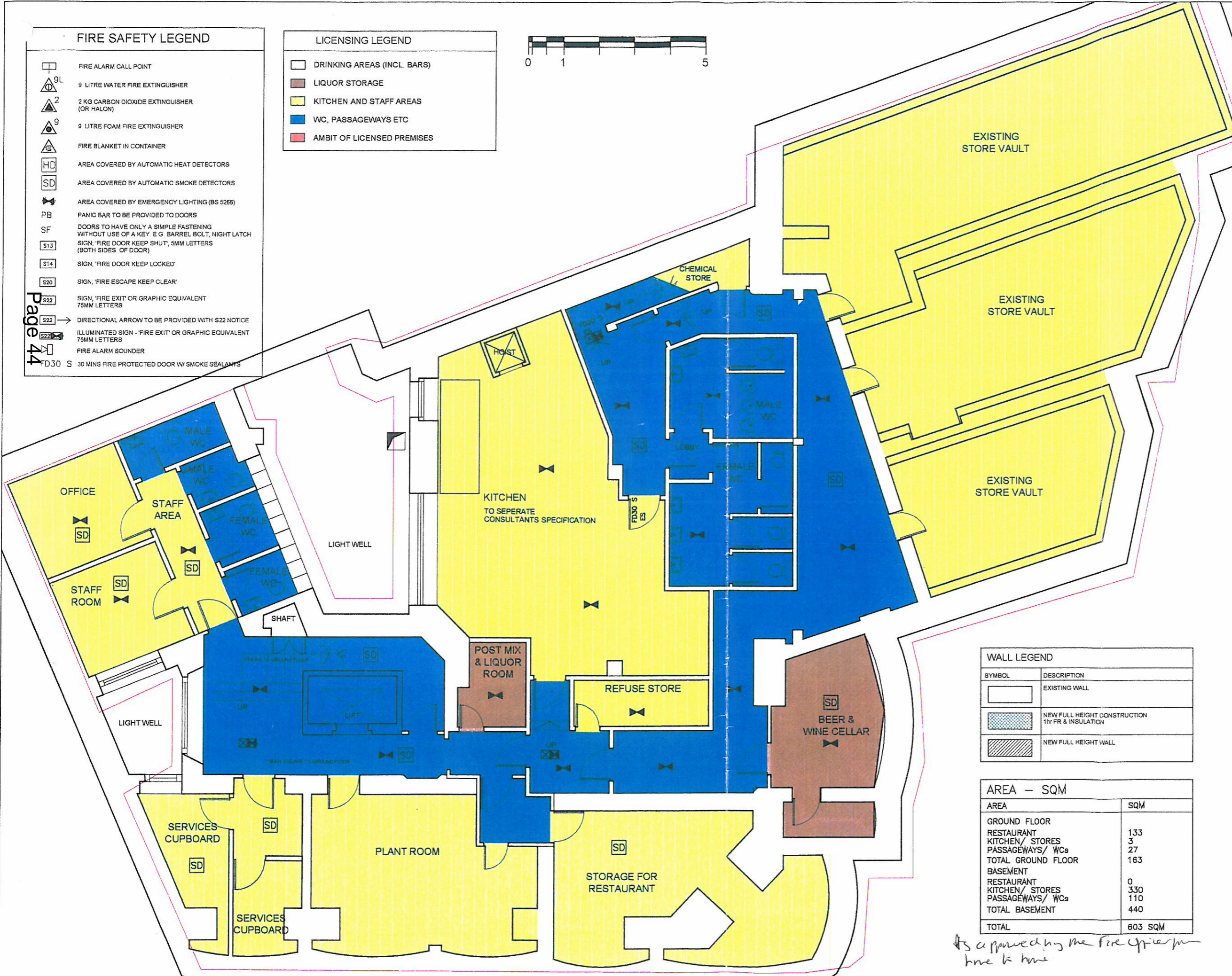

WALL LEGEND

SYMBOL	DESCRIPTION
	EXISTING WALL
	NEW FULL HEIGHT CONSTRUCTION 1hr FR & INSULATION
	NEW FULL HEIGHT WALL

AREA - SQM

AREA	SQM
GROUND FLOOR	
RESTAURANT	133
KITCHEN/ STORES	3
PASSAGEWAYS/ WCs	27
TOTAL GROUND FLOOR	163
BASEMENT	
RESTAURANT	0
KITCHEN/ STORES	330
PASSAGEWAYS/ WCs	110
TOTAL BASEMENT	440
TOTAL	603 SQM

*As approved by the Fire Officer
line to line*

REVISIONS

Rev.	Date	Comment
A.	23.06.04	DESIGN REVISION BAR ADDED FURNITURE PLAN CHANGED

- © MARTIN BRUDNIZKI DESIGN STUDIO LTD 2003
- NOTES**
- THE DRAWING SHOW DESIGN INTENT ONLY. ALL DIMENSIONS TO BE CHECKED ON SITE PRIOR TO CONSTRUCTION OR PRODUCTION CONSTRUCTION DETAILS TO BE CONFIRMED BY CONTRACTOR MANUFACTURER BY SUBMITTING SHOP DRAWINGS FOR DESIGNER'S APPROVAL.
 - DESIGN / DRAWING IS NOT TO BE SCALED FOR PRODUCTION AND CONSTRUCTION PURPOSES
 - ALL DISCREPANCIES AND OMISSIONS ON SITE MUST BE REPORTED TO DESIGNER FOR THEIR COMMENTS OR APPROVAL PRIOR TO COMMENCING WORK.
 - ALL ELECTRICAL, LIGHTING, HVAC AND PLUMBING ISSUES TO BE REFERRED TO ENGINEER'S DRAWINGS PRIOR TO COMMENCEMENT OF WORKS.
 - THE DESIGNS ARE SUBJECT TO APPROVAL BY STATUTORY AUTHORITIES AND ANY NECESSARY ALTERATIONS SHOULD BE MADE IF REQUIRED TO COMPLY WITH STATUTORY REQUIREMENTS.
 - ALL DESIGN CONCEPTS AND DRAWINGS ARE THE PROPERTY OF MARTIN BRUDNIZKI AND ARE COVERED BY COPYRIGHT. NO REPRODUCTIONS, ADAPTATIONS AND/OR COPIES MAY BE MADE WITHOUT WRITTEN PERMISSION BY MARTIN BRUDNIZKI.

Project
4 ST. PAUL'S CHURCHYARD

Title
PLAN PROPOSALS
PAGE 2 OF 2

Date 23.06.04 Scale 1:100@A3

Drwg No 6004-L4 Rev. A Auto Cad ref 6004\$

MARTIN BRUDNIZKI
DESIGN STUDIO LTD
Unit 2L Chelsea Reach
79-89 Lots Road London SW10 0RN
Tel +44 (0)20 7376 7555
Fax +44 (0)20 7376 7444